

# RAUTER

Sensor-Boxes

Ex 8V - 45°C limit switch boxes for zone 1, 2 + 21, 22

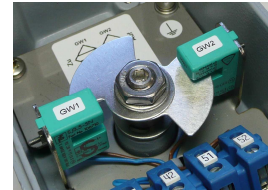
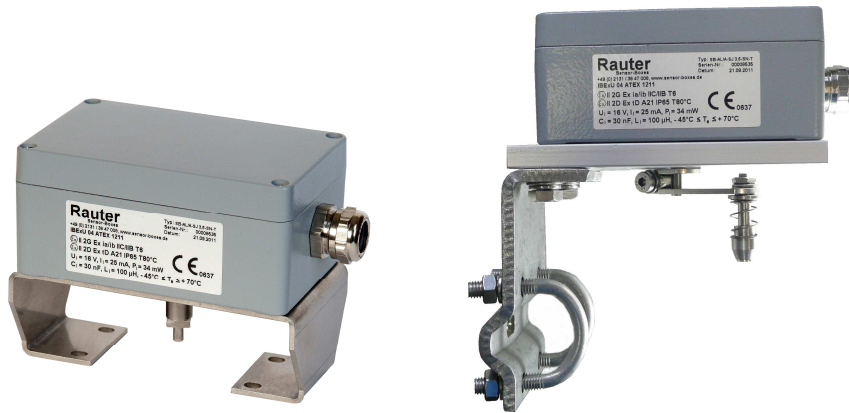

Pepperl+Fuchs SJ 3,5-SN

## technical data limit switch boxes

ATEX identification	II2G Ex ia/ib IIC/IIB T6 II2D Ex ia/ib IIIC T80°C
temperature range	- 45°C ≤ T <sub>a</sub> ≤ + 70°C
protection class	IP 65
material housing	AL = aluminium = ALSi-12, grey RAL 7001
dimensions housing	125x80x57mm
cable glands	M20x1,5mm, Ms or stainless steel, Ø 13-9,0mm
weight without bracket	0,5 kg
option	membrane vent for avoidance of condensation water
braket connection	F05 slot
actuator connection	- acc. to VDI/VDE 3845, steam hight 20, 30 and 50mm, hole spacing 80x30 mm u. 130x30mm - mounting set f. linear actuators acc. to IEC 534

## technical data limit switches

sensor type	Pepperl+Fuchs SJ 3,5-SN
nominal voltage	8V DC
nominal current	detected ≤ 1mA / undetected ≥ 3mA
switching frequency	0 ... 3000Hz
switching range	0°+ 90°, 0°+ 180° or adjustable
output wire	2-wire
switching function	NAMUR normally closed = NC
output polarity	safety function
acc. to IEC 61508	usable up to SIL3

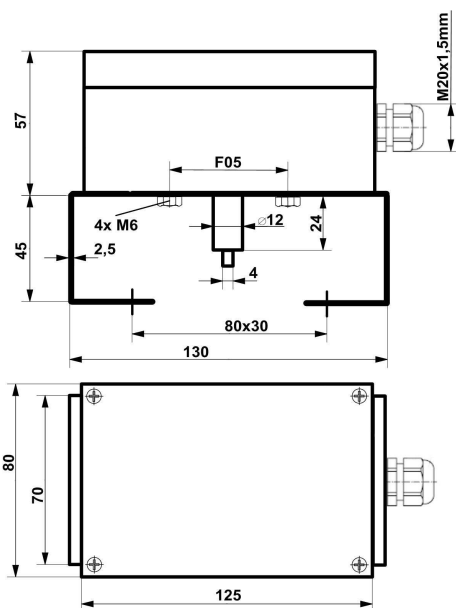

dimensions

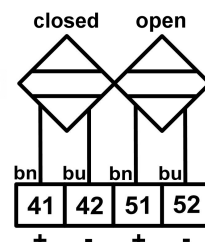
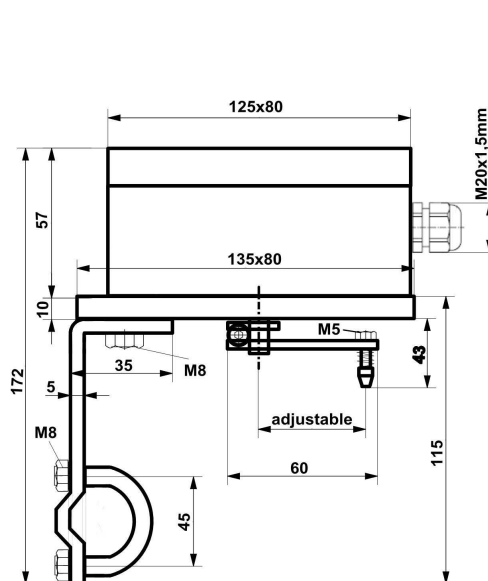

wiring diagram